

## LESSON 22: Scale Drawings

## Homework

.....  
**Name** \_\_\_\_\_ **Date** \_\_\_\_\_

**Directions:** Solve the following problems using what you have learned about scale drawings.

1. The distance between two cities on a map is 6 cm. If the scale on the map is 2 cm = 50 miles, how many miles apart are the two cities?

**Directions:** Use the scale drawing below to answer Questions 2 - 6.

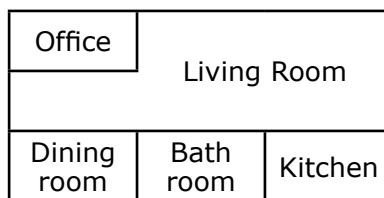

Scale: 2 in. = 1 ft

2. Jenna's father is going to use the blueprint above to make a house play for her. In the drawing, the length of the entire first floor is 12 in. What is the actual length?
3. The width of the entire first floor in the drawing is 8 in. What is the actual width?
4. What scale factor did Jenna's father use to go from the drawing to the actual house?
5. What is the perimeter of the first floor Jenna's that father built?
6. What is the area of the first floor Jenna's that father built?